

# 9103

Stainless Steel, Environmentally Sealed, NTEP Certified 1:10,000 Class III Multiple Cell, IP67



## APPROVALS



## Dimensions

Picture is a representation of actual product

Rated Capacity	A	B	C	D	E	F	G	H	J	K	L
<b>lb/in</b>											
5,000-10,000	8.12	4.06	1.44	1.12	0.62	6.88	0.62	0.66	1.70	1.48	0.50
20,000	8.12	4.06	1.44	1.12	0.62	6.88	0.84	0.66	1.95	1.48	0.50
30,000-60,000	10.25	5.12	1.88	2.37	0.88	8.50	1.00	1.06	3.00	2.73	1.00
100,000	11.25	5.62	1.88	2.50	0.88	9.50	1.00	1.06	3.50	3.24	1.50
150,000	11.25	5.62	1.88	2.80	0.88	9.50	1.25	1.06	3.90	3.64	1.50
<b>kg/mm</b>											
2,268.0-4,535.9	206.3	103.1	36.6	28.5	15.8	174.8	15.8	16.8	43.2	37.6	12.7
9,071.9	206.3	103.1	36.6	14.2	21.3	174.8	21.3	16.8	49.5	37.6	12.7
13,607.8-27,215.6	260.4	130.1	47.8	60.2	22.4	215.9	25.4	26.9	76.2	69.3	25.4
45,359.4	285.8	142.8	47.8	63.5	22.4	241.3	25.4	26.9	88.9	82.3	25.4
68,093.1	285.8	142.8	47.8	63.5	22.4	241.3	31.8	26.9	99.1	92.5	38.1

## Order Information

Load Rating	Part #	Est. Weight	Price
<b>NTEP Certified</b>			
10,000 lb	17329	5 lb	Consult
20,000 lb	17330	5 lb	Consult
30,000 lb	17331	19 lb	Consult
40,000 lb	17332	19 lb	Consult
50,000 lb	17333	19 lb	Consult
60,000 lb	17334	19 lb	Consult
100,000 lb	17335	30 lb	Consult
<b>Non-NTEP Certified</b>			
5,000 lb	17328	5 lb	Consult
150,000 lb	17336	30 lb	Consult
<b>Conduit Adapter Kit (must be factory installed to maintain warranty)</b>			
3/8-24 to 1/4-18NPT	31534	1 lb	Consult
5/8-18UNF to 1/2-14 NPT	31535	1 lb	Consult

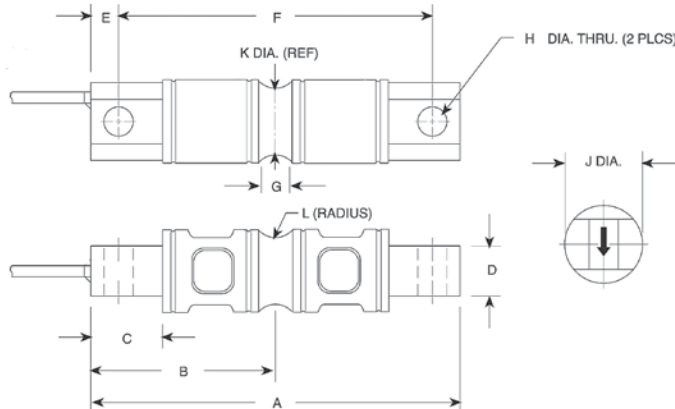

## Interchangeable Products

RICE LAKE WEIGHING SYSTEMS  
**RL70000SS** ..... page 156

## Weigh Module Available

RICE LAKE WEIGHING SYSTEMS  
**EZ Mount 1** ..... page 86

## Specifications

**Full Scale Output:**  
3.0 mV/V

**Output Resistance:**  
700 (± 7) ohm

**Input Resistance:**  
700 (± 7) ohm

**Material/Finish:**  
Stainless steel

**Temperature:**  
Compensated range  
14°F to 104°F (-10°C to 40°C)  
Operating range  
0°F to 150°F (-18°C to 65°C)

**Seal Type:**  
Environmentally sealed, IP67

**Safe Overload:**  
150% full scale

**Safe Sideload:**  
100% full scale

**Rated Excitation:**  
5- 10 VDC (15 V maximum)

**Non-repeatability:**  
0.02% full scale

**Combined Error:**  
0.03% Full scale

**Insulation Resistance:**  
5,000 megohms

**Deflection at Capacity:**  
5,000 lb=0.02 in (0.5 mm)  
10,000 lb=0.025 in (0.6 mm)  
20,000 lb=0.042 in (1.1 mm)  
30,000 lb-50,000 lb=0.02 in (0.5 mm)  
60,000 lb=0.025 in (0.6 mm)  
100,000 lb-150,000 lb=0.02 in (0.5 mm)

**Cable Length:**  
30 ft (9.2 m)

**Cable Diameter:**  
0.295 polyurethane jacket

**Cable Color Code:**  
Red +Excitation  
Black -Excitation  
Green +Signal  
White -Signal

**Warranty:**  
One-year limited warranty

**Approvals:**  
cFMus  
NTEP