



APPROVALS



Interchangeable Products

VPG REVERSE®	392B	—
ARTECH®	90210	—
CARDINAL®	CPI	—
HOWE RICHARDSON®	20908XXX	—
STREETER AMET®	3753070, 3752030, 3752040, 3751940	—

Weigh Module Available

RICE LAKE WEIGHING SYSTEMS
MagnaMount® page 103

Dimensions

Picture is a representation of actual product

Rated Capacity	A	B	D	E	F	G	H	DEPTH of H
lb/in								
10,000-50,000	2.48	3.25	6.00	3.30	0.40	1.25	1/2-20 UNF	0.31
100,000	4.12	5.00	6.00	3.50	0.51	2.31	3/4-16 UNF	0.56
200,000-300,000	6.00	7.25	17.00	4.60	1.04	3.13	3/4-16 UNF	0.75
500,000	6.50	9.00	17.00	4.80	0.56	3.69	3/4-16 UNF	0.75
kg/mm								
4,535.9-22,679.6	72	82.6	152.4	83.8	10.2	31.8	1/2-20 UNF	7.9
45,359.2	104.7	127.0	152.4	88.9	13.0	58.7	3/4-16 UNF	14.2
90,718.5-136,077.7	152.4	184.2	431.8	116.8	26.4	79.5	3/4-16 UNF	19.1
226,796.2	165.1	228.6	431.8	121.9	14.2	93.7	3/4-16 UNF	19.1

Order Information

Load Rating		Part #	Est. Weight	Price
10,000 lb	4,535.9 kg	17588	8 lb	Consult
25,000 lb	11,339.8 kg	17589	8 lb	Consult
50,000 lb	22,679.6 kg	17590	8 lb	Consult
100,000 lb	45,359.2 kg	17591	16 lb	Consult
200,000 lb	90,718.5 kg	17592	40 lb	Consult
300,000 lb	136,077.7 kg	17593	40 lb	Consult
500,000 lb	226,796.2 kg	17594	53 lb	Consult

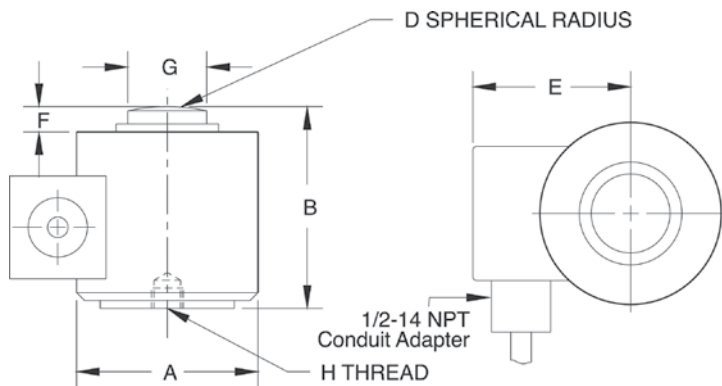

Specifications

- Full Scale Output:**
1.75 mV/V
- Output Resistance:**
480 (± 4.8) ohm
- Input Resistance:**
450 (± 4.5) ohm
- Material/Finish:**
Stainless steel
- Temperature:**
Operating range
0°F to 150°F (-18°C to 65°C)
- Seal Type:**
Welded-seal, IP68
- Safe Overload:**
150% full scale
- Rated Excitation:**
5- 10 VDC (15 V maximum)
- Combined Error:**
0.15% full scale
- Non-repeatability:**
0.03% full scale
- Insulation Resistance:**
5,000 megohms
- Deflection at Capacity:**
10,000 lb-50,000 lb=0.003 in (0.76 mm)
100,000 lb-300,000 lb=0.006 in (0.152 mm)
500,000 lb=0.009 in (0.228 mm)
- Cable Length:**
30 ft (9.2 m)
- Cable Diameter:**
0.295 polyurethane jacket
- Cable Color Code:**
Green +Excitation
Black -Excitation
White +Signal
Red -Signal
- Warranty:**
One-year limited warranty
- Approvals:**
cFMus