

**Interchangeable Products**

RICE LAKE WEIGHING SYSTEMS  
**AX3040**  
 VPG REVERE®  
**8300420-10**

**Specifications**

- Full Scale Output:**  
0.5 mV/V at 12,500 lb
- Output Resistance:**  
350 (nominal)
- Input Resistance:**  
350 (nominal)
- Material/Finish:**  
Alloy steel
- Temperature:**  
14° F to 104° F (-10° C to 40° C)
- Rated Excitation:**  
15VDC
- Non-linearity:**  
±1.0% full scale
- Insulation Resistance:**  
500 megohms @ 50VDC
- Seal Type:**  
Environmentally sealed, IP66
- Connector Type:**  
7-pin
- Connector Pin Out:**  
 A - Signal + (white)  
 C - Excitation - (black)  
 D - Excitation + (red)  
 F - Signal - (green)  
 F - Shield
- Warranty:**  
One-year limited warranty

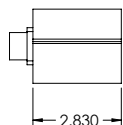
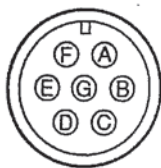

**Order Information**

*Picture is a representation of actual product*

Load Rating	Part #	Est. Weight	Price
Static 30,000 lbs	111766	30 lbs	Consult
Dynamic 20,000 lbs			

**Load Cell Cable Option**

Part #	Description	Price
112119	2 ft cable with 90° connector	Consult
112121	3 ft cable with connector	Consult
114628	10 ft cable with 90° connector	Consult
112120	17 ft cable with 90° connector	Consult

