

REVISIONS							
ZONE	LTR.	DESCRIPTION	DATE	ECN	BY	CKD	APVD
-	-	INITIAL RELEASE	10/01/08	-	-	-	-
-	-	EDIT DIMENSION TABLE	09/09/09	-	-	-	-
-	E	CHANGED RATED OUTPUT TO $\pm 0.25\%$	01/02/16	2021-03	GC	AT	AT

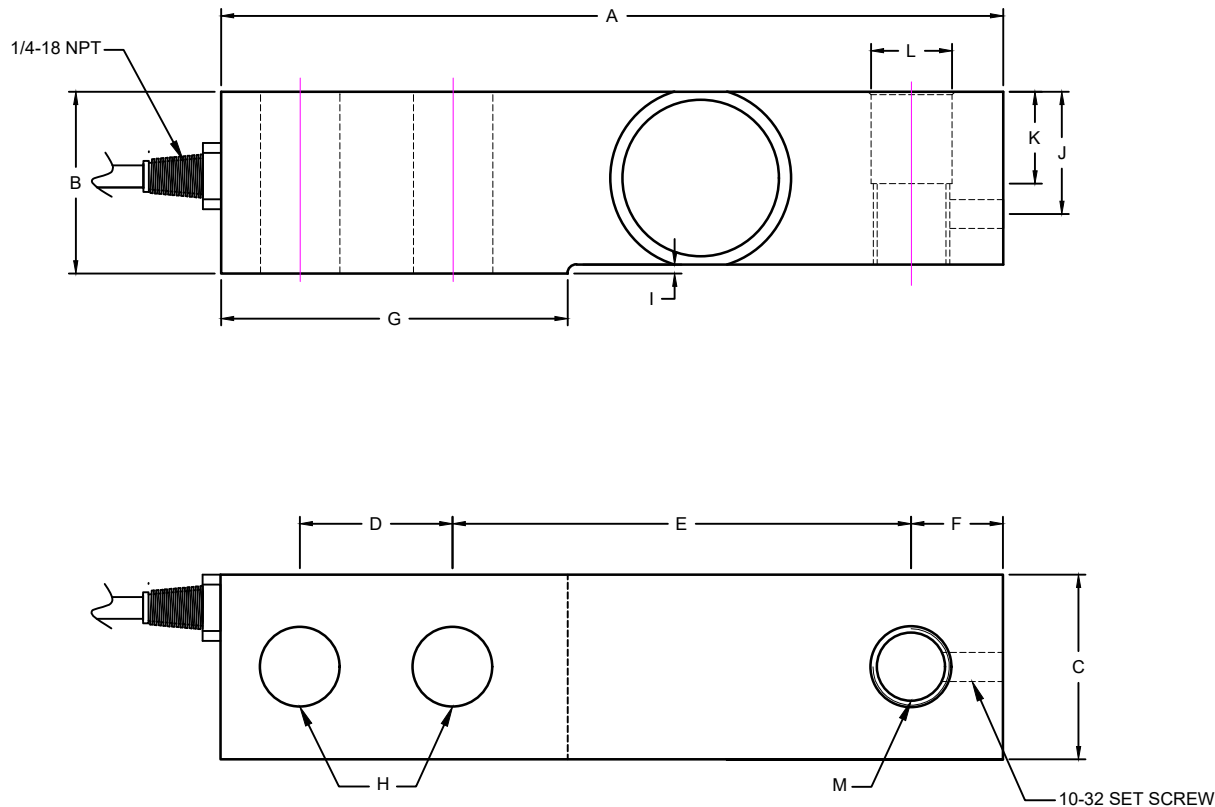

PERFORMANCE SPECIFICATIONS:

1. CAPACITIES: 1K, 2.5K, 4K, 5K, & 10K LB.
2. RATED OUTPUT: 3.00 mV/V $\pm 0.25\%$.
3. SAFE OVERLOAD: 150% FS.
4. EXCITATION VOLTAGE: 10V AC/DC (20V MAX) .
5. INPUT RESISTANCE: 1080 $\pm 10\Omega$.
6. OUTPUT RESISTANCE: 1000 $\pm 5\Omega$.
7. ZERO BALANCE: $\pm 1.00\%$ FS.
8. SEAL TYPE: WELDED- SEAL.
9. NON-LINEARITY: $\pm 0.03\%$ FS.
10. HYSTERESIS: $\pm 0.03\%$ FS.
11. REPEATABILITY: $\pm 0.01\%$ FS.
12. CREEP: $\pm 0.02\%$ FS
13. COMPENSATED TEMPERATURE RANGE: -10°C TO +40°C.
14. TEMPERATURE EFFECT ON ZERO: $\pm 0.0027\%$ FS/C°.
15. TEMPERATURE EFFECT ON OUTPUT: $\pm 0.0015\%$ FS/C°.
16. INSULATION RESISTANCE: 5000 MEGOHMS.
17. LOAD CELL CABLE: 4 CONDUCTOR, 20FT.
18. LOAD CELL WIRING:
 - GRN (+EXC)
 - BLK (-EXC)
 - WHT (+SIG)
 - RED (-SIG)
 - YELLOW (SHIELD)

19. FM APPROVED.

RATED CAPACITY	DIMENSIONS												
	A	B	C	D	E	F	G	H	I	J	K	L	M
1K-4K	5.12	1.19	1.21	1.00	3.00	0.60	2.27	0.52	0.065	0.80	0.60	0.53	1/2-20UNF
5K	6.75	1.44	1.45	1.50	3.75	0.75	3.00	0.78	0.090	1.00	0.67	0.78	3/4-16UNF
10K	6.75	1.69	1.69	1.50	3.75	0.75	3.00	0.78	0.090	1.30	0.80	0.78	3/4-16UNF



DO NOT ALTER WITHOUT AGENCY NOTIFICATION

Coti Global Sensors
MANUFACTURING

Weighing Products Worldwide

APPROVALS		DATE
DRAWN:	TB	01/02/16
CHECKED:	AA	01/02/16
ENGINEER:	TB	01/02/16
APPROVED:	AA	01/02/16
MATERIAL: STAINLESS STEEL		

THIS DOCUMENT CONTAINS PROPRIETARY INFORMATION AND SUCH INFORMATION MAY NOT BE REPRODUCED OR DISCLOSED FOR ANY PURPOSE OR USED TO PRODUCE THE ARTICLE OR SUBJECT WITHOUT WRITTEN PERMISSION FROM COTI GLOBAL SENSORS, INC.

TOLERANCES UNLESS OTHERWISE SPECIFIED
 .XX \pm 0.02"
 .XXX \pm 0.005"
 .XXXX \pm 0.0002"
 FRACTIONS $\pm 1/16$ "
 ANGLES DEG. $\pm 1/8$

SCALE	SIZE	PART/DRAWING NO.	REV.
NONE	B	DOD-CG-BLC-T	E
MODEL CG-BLC-T			SHEET 1 OF 1