

L6N



test certificate no. D09-06.11 Revision 1
 C of C no R60/2000-CNI-06.04



Certificate no. 11-055

- Aluminium-alloy IP65 single point load cell.
- Colourless anodized
- Suitable for single or double load cell structured platform scales
- Maximum platform size: 400 x 400 mm

Available models

Capacity	Accuracy	Full article description
3 kg	C3	L6N-C3-3kg-3B6
5 kg	C3	L6N-C3-5kg-3B6
8 kg	C3	L6N-C3-8kg-3B6
10 kg	C3	L6N-C3-10kg-3B6
15 kg	C3/C4	L6N-C3/C4-15kg-3B6
20 kg	C3/C4	L6N-C3/C4-20kg-3B6
30kg	C3/C4	L6N-C3/C4-30kg-3B6
40kg	C3/C4	L6N-C3/C4-40kg-3B6
50kg	C3/C4	L6N-C3/C4-50kg-3B6
75kg	C3/C4	L6N-C3/C4-75kg-3B6
100kg	C3	L6N-C3-100kg-3B6

Specification

Accuracy class		OIML R60 C3	OIML R60 C4
Output sensitivity (= FS)	mV/V	2.0 ± 0.2	
Maximum capacity (Emax)	kg	3, 5, 8, 10, 15, 20, 30, 40, 50, 75, 100	15, 20, 30, 50, 75
Maximum number of load cell intervals (nLC)		3000	4000
Ratio of minimum LC verification interval Y = Emax / vmin		20000	
Combined error	%FS	± 0.02	± 0.015
Minimum dead load	of Emax	0%	
Safe overload	of Emax	120 %	
Ultimate overload	of Emax	150 %	
Zero balance	%FS	± 2.0	
Excitation, recommended voltage	V	5 ~ 12(DC)	
Excitation maximum	V	18(DC)	
Terminal resistance, input	Ω	406 ± 6	
Terminal resistance, output	Ω	350 ± 3	
Insulation impedance	MΩ	≥ 5000 (at 50VDC)	
Temperature range, compensated	°C	-10 ~ +40	
Temperature range, operating	°C	-35 ~ +65	
Storage temperature	°C	-40 ~ +70	
Element material		Aluminium	
Recommended torque on fixation bolts	N.m	M6: 10	
Ingress Protection (according to EN 60529)		IP65	

Dimensions in mm

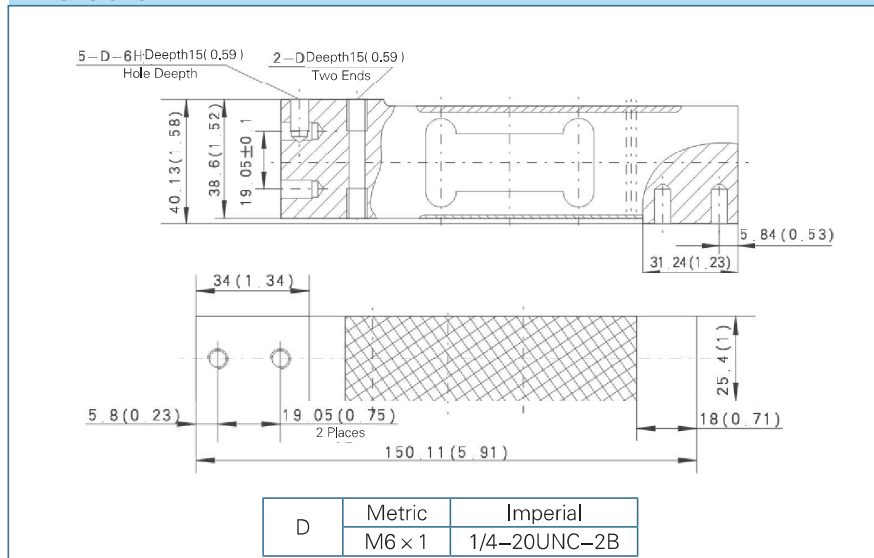

Wiring

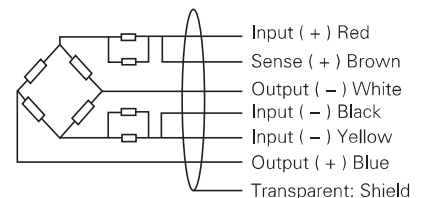

- Shielded, 6 conductor cable.
- Cable Diameter: $\Phi 4.8\text{mm}$
- Standard cable length: 3m
- Shield not connected to element.
- Cable jacket is PVC.